

# MIDIFUSE IN-LINE HOLDER

Bussmann

Part Number	Description
IFH-AM1-M5	Assembled holder includes hardware.

**Voltage:** 32V

**Rating:** 200A

**Bolts:** Zinc plated steel M5 12mm x 0.8 bolts

**Block:** Black rynite thermoplastic with brass inserts

**Accessories:** Includes 2 bolts & lock washers

**Pack Size:** 1, 10, 100

**Notes:** Midifuse is not included.

**Approvals:** [RoHS](#)

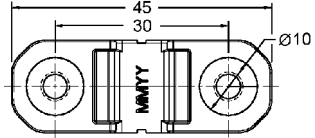
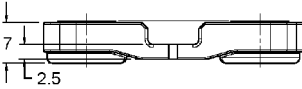

Dimensions in MM

# MIDIFUSE IN-LINE HOLDER WITH COVER

Littelfuse

The inline Midifuse holder is designed for use with bolt-down Midifuses. It may be installed directly inline with the cables with no mounting required. The Inline Midifuse holder can be used with heat shrink tubing for applications requiring more splash resistance. The curved design of the cover aids in prevention of tube-splitting during application.

Part Number	Description
04980921 GXM5	Assembled holder includes cover and hardware.

**Voltage:** 32V

**Rating:** 200A

**Operating Temperature Range:** -40°C to +125°C

**Max. Wire Size:** 20mm<sup>2</sup>

**M5 Torque Rating:** 5Nm

**Base/Cover Material:** UL 94V-0 glass-filled nylon

**Bolts:** Zinc plated steel M5 x 0.8

**Hardware:** Zinc-plated steel nuts with nylock inserts (included).

**Pack Size:** 1, 10, 100

**Notes:** Midifuse is not included.

**Approvals:** [RoHS](#)

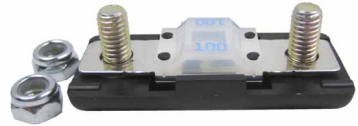

Assembled Holder



## COMPONENTS:

Midifuse fuses see page 29



Midifuse

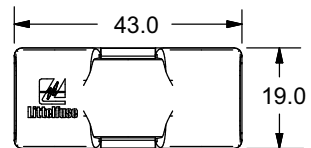
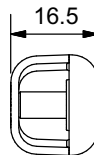

Dimensions in MM