

IQ-40-HOUR



Extended Bulk Charging for Larger Systems

For lead-acid battery banks with increased Amp-Hour ratings, the IQ-40-Hour delivers an extended Bulk charge duration to service the larger capacity before reverting to standard ABSORPTION, FLOAT, and MAINTENANCE modes.

Charging Profile

The IQ-40-HOUR progresses through the following stages while charging your batteries:

BULK (EXTENDED)	The Bulk Stage of the IQ4 allows the batteries to be charged from the full rated output of the charger. This increased charging period reduces the overall charging time of the battery.
FLOAT	During the Float Stage, the IQ4 reduces the DLS charge voltage. This reduced voltage maintains the full charge while minimizing 'gassing' of the battery. The IQ4's float stage prevents boiling and bulging of the battery caused when the battery is exposed to higher charging voltages for too long.
MAINTENANCE	If the batteries remain in a "float stage" for a seven-day period, the IQ4 will switch the DLS charger into a pre-programmed Maintenance Stage. This protects the life of your battery by dissolving any sulfate layer on the battery's internal plates and avoids stratification that can occur when a battery has not been in use for extended periods.

Installation

The IQ Smart Charge Controller easily plugs into the Dual Voltage Jack* of your IOTA DLS Battery Charger. Once plugged in, the IQ Smart Charge circuitry is automatically engaged and your IQ module will activate. Your DLS will now provide an automatic and trouble free charging profile to your batteries!

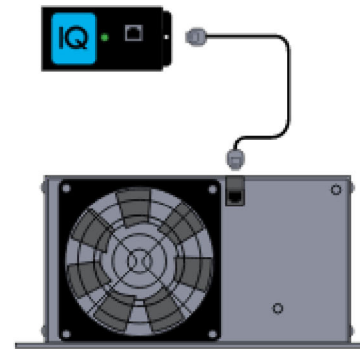

*Location of the Dual Voltage Jack may vary depending on the IOTA DLS Model

Note: External IOTA IQ Smart Charge Controllers are not compatible with DLS with internal IQ charge control.